

DISCS

EXTREME PERFORMANCE BRAKE ROTORS

Braking rotors are among the newest products in the Sinter product line, and a lot of customization is possible. Our R&D is focused heavily on new composite materials.

For a full list of discs see page 33.



HIGH CARBON GREY CAST IRON

We have partnered with the local university and metallurgical laboratories to develop the new high carbon grey cast iron rotor.

These high-performance cast-iron brake rotors work perfectly with Sinter brake pads – available both as OEM and aftermarket.

SINTER(シンター)社製ブレーキディスクは受注発注商品です。ご興味あられる方は弊社までお気軽にお問合せくださいませ。

info@intrepid-japan.com

KARTING DISCS

1D1-160-026-4

RIMO / MAGURA Rear Diameter (mm) - 160
Material - GJS 600 Thickness (mm) - 4,5

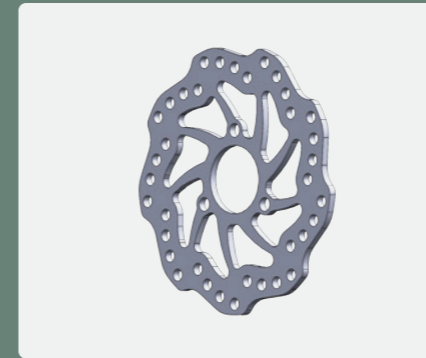

1D1-150-001-5 (right)

Mach 1 Front Diameter (mm) - 150
Material - GJL 250 Thickness (mm) - 10

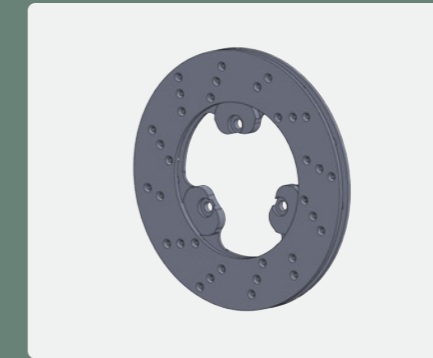

1D1-150-002-5 (left)

Mach 1 Front Diameter (mm) - 150
Material - GJL 250 Thickness (mm) - 10



1D1-190-024-5

MACH 1 Rear Diameter (mm) - 150
Material - GJL 250 Thickness (mm) - 12

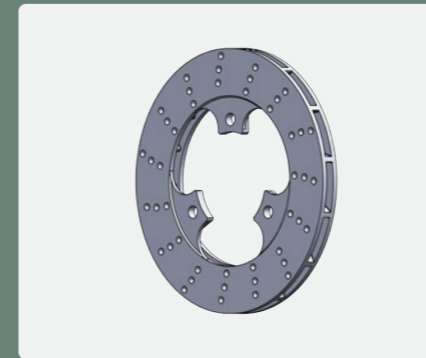

1D1-198-023-5

MACH 1 Rear Diameter (mm) - 198
Material - GJL 250 Thickness (mm) - 14



1D1-150-080-5

CRG Front Diameter (mm) - 150
Material - GJL 250 Thickness (mm) - 12

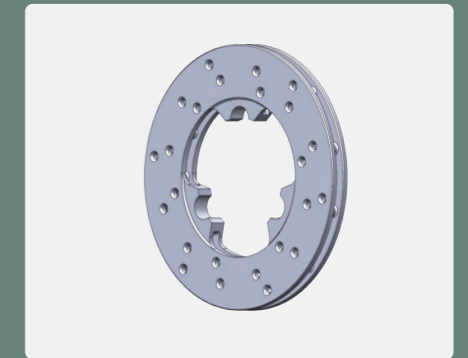

1D1-154-080-5

CRG Front Diameter (mm) - 154
Material - GJL 250 Thickness (mm) - 12,6

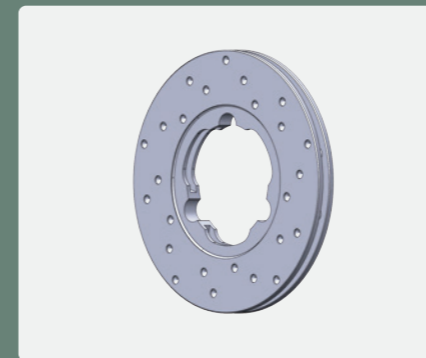

1D1-195-020-5

CRG Rear Diameter (mm) - 195
Material - GJL 250 Thickness (mm) - 18,5

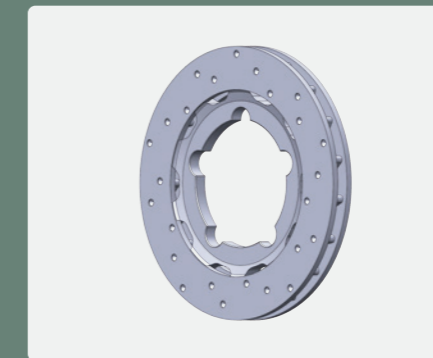

1D1-187-027-5

IPK Rear Diameter (mm) - 187
Material - GJL 250 Thickness (mm) - 14

